



USER MANUAL

THE RURAL BUTCHER ELECTRIC VACUUM PUMP

IMPORTANT SAFETY INSTRUCTIONS

Please read the user manual carefully before using and follow the safety instructions.

1. This product is used for air valve bags, vacuum canister, mason jars, wine stopper, etc.
2. Please use this product according to the instructions in this manual. This product is for indoor use only, do not use this product for an unintended use.
3. Children are not allowed to use this product, and do not use the vacuum pump on any part of the body.
4. Keep this product away from children.
5. Make sure the product is assembled correctly before using.
6. Before using the vacuum pump for the first time, please fully charge the vacuum pump. Approx. 2-5 hours for charging.
7. The indicator light flickers while vacuuming, and when the red indicator light flashes slowly, it indicates that the battery is low and needs to be charged.
8. The red light is on when the vacuum pump is charging, and the green light is on when it is fully charged.
9. When vacuuming, the vacuum pump must be aligned with the air valve, and the effect will be better if pressing the vacuum pump by hand lightly when vacuuming.
10. Do not immerse the vacuum pump in water or other liquids. Clean the vacuum pump with dry or slight soaked cloth, and it is **not suggested** to wash it in dishwasher.
11. Do not use this product continuously for more than 20 minutes.
12. Clean the silicone air inlet at the bottom of the vacuum pump regularly.

PRODUCT STRUCTURE

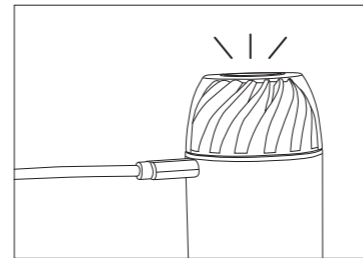
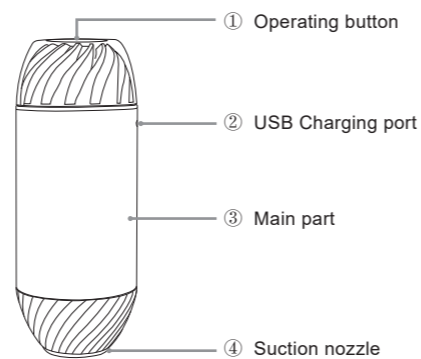

When the red indicator light flashes slowly, it indicates that the battery is running low and needs to be charged. The red light is on when the vacuum pump is charging, and the green light is on when it is fully charged.

OPERATION INSTRUCTION (Take the air valve bag as an example)

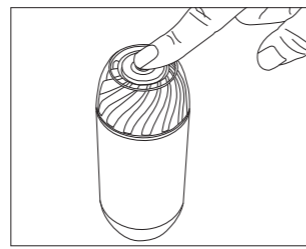

1. Press and hold for 2 seconds to activate the pump.

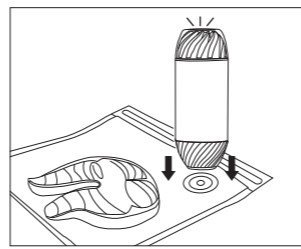

2. The indicator light flashes during operation. Align the suction nozzle with the port and press it lightly to vacuum.

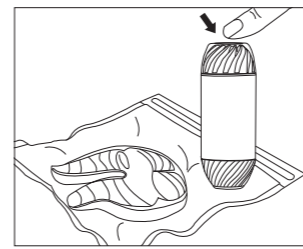

3. It will stop automatically when reaching set negative pressure. Or you can press the button again to stop it manually.

APPLICATION FUNCTIONS

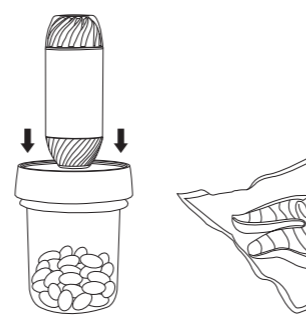

Mason jar

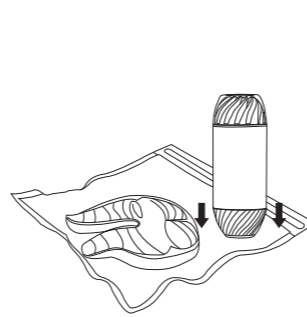

Vacuum air valve bag

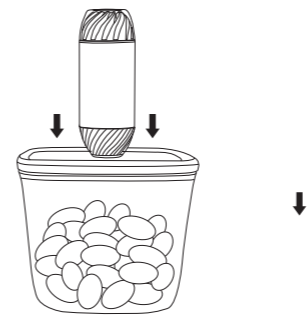

Vacuum container

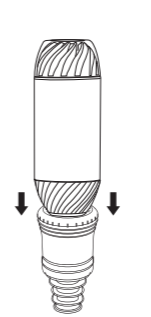

Vacuum wine stopper

PACKAGE CONTENTS

No.	Description	Image	QTY
1	Vacuum pump		1
2	USB charging cable		1
3	User manual		1

SPECIFICATION

Item	Specification
Model number	BU260
Product size	D50*131mmH
Battery capacity	3.7V@2000mAh
Charging type	5V@1A/5V@2.1A
Rated power	MAX 3W
Vacuum degree	60Kpa (Negative pressure > -20Kpa)
Pump capacity	3.0L/MIN
Net weight	220g
Gross weight	250g
Material	ABS/PC+aluminum alloy+silicone

The Rural Butcher, 42 Johnston Way
Whakatu, Hastings, 4180
sales@ruralbutcher.co.nz | 0800 843 024

Do not dispose of electrical appliances as unsorted municipal waste, use separate collection facilities. Contact your local government for information regarding the collection systems available. If electrical appliances are disposed of in landfills or dumps, hazardous substances can leak into the groundwater and get into the food chain, damaging your health and well-being.